

Trailer Coupler and Jack Displays

- Allows consumers to see how the product will look for their application
- When used on Wide Span, stock can be stored above and below display for self-service shopping

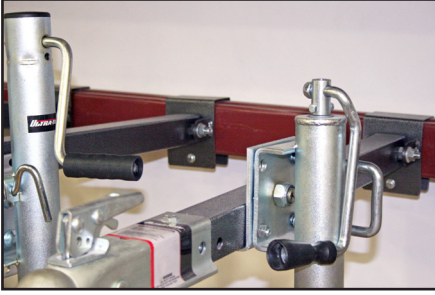

Trailer Hitch Support Arm



A-Frame Trailer Coupler Angled

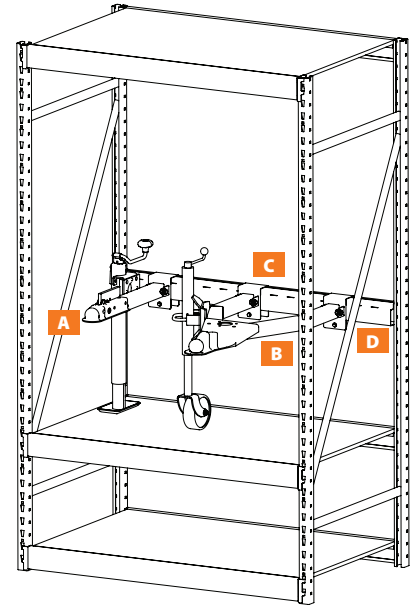

A Trailer Hitch Support Arm

- Use for single trailer tongue
- Jack can be attached as well
- For each arm order one Trailer Hitch Bracket (THSB)

THSA(NL)

THSA.....Trailer Hitch Support Arm
 NL.....Nominal Length 10" to 28" in 2" increments
 and 40" (254 mm to 711 mm in 51 mm
 increments and 1016 mm)

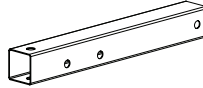

B A-Frame Trailer Coupler Angled

- Use for A-frame trailer tongue
- Two required when used with a-frame
- For each arm order two Trailer Hitch Brackets (THSB)

AFTCA(NL)

AFTCA.....A-Frame Trailer Hitch Coupler Angled
 NL.....Nominal Length
 Blank=16" (406 mm)
 28=28" (711 mm)

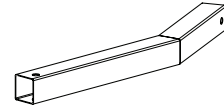

C Trailer Hitch Support Bracket

- Bracket saddles rear beam
- Both arms attach to Trailer Hitch Support Bracket (THSB) with a bolt
- For each arm order one Trailer Hitch Brackets (THSB)

THSB

THSB.....Trailer Hitch Support Bracket

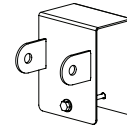

D Adjustable Tire Beam

- Use as rear beam for Trailer Hitch Support Arm [THSA(NL)]
- Trailer Hitch Support Bracket (THSB) saddles Adjustable Tire Beam
- Use 3.5 and 1 step beam for this application

Q10871-(NH)(NL)-1

Q10871Wide Span Tire Display
 NH.....Nominal Beam Height
 35=3.5" (89 mm)
 50=5" (127 mm)
 60=6" (152 mm)
 NL.....Nominal Length 36" to 144" and 150"
 (914 mm to 3658 mm and 3810 mm)
 1Step Depth

