

## Maxispan

Maxispan shelving is the most effective use of floor space for above display storage. It completely spans continuous Gondola runs when Hypermaxi's height precludes its use and yet it still gives you the load capacity of our Pallet Rack system. High load capacity and space saving efficiency in a single highly customizable solution.

- Maxispan must be anchored to floor
- Each frame requires 4 anchors
- Maxispan column load capacity is 20,000 lbs. Use this figure in the column loading chart to determine the beam loading per section, or consult your Madix representative for specific capacities for your application
- Spacing over 48" (1219 mm) vertically reduces column load capacity due to lack of support to channel
- When lowest beam is 48" (1219 mm) or higher from floor, always secure frame to floor

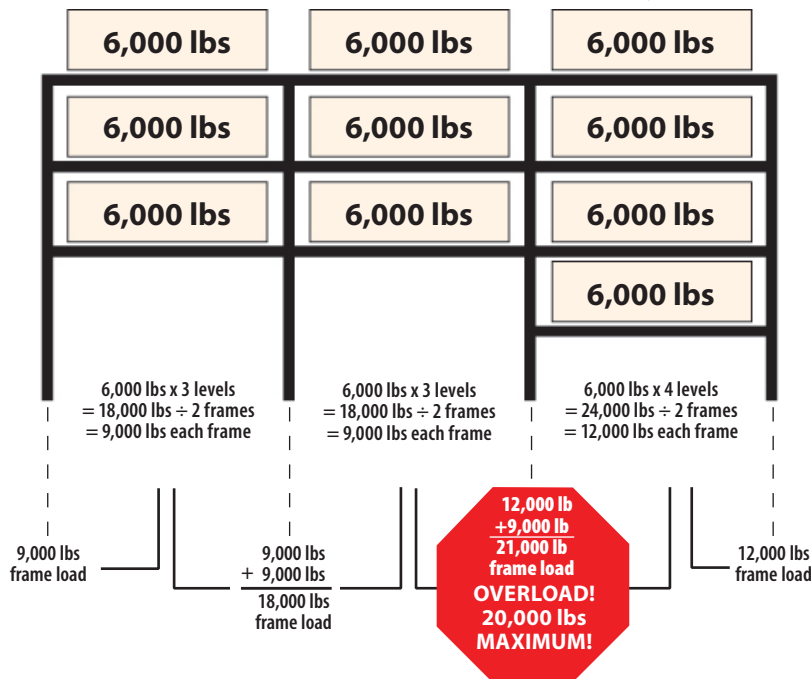
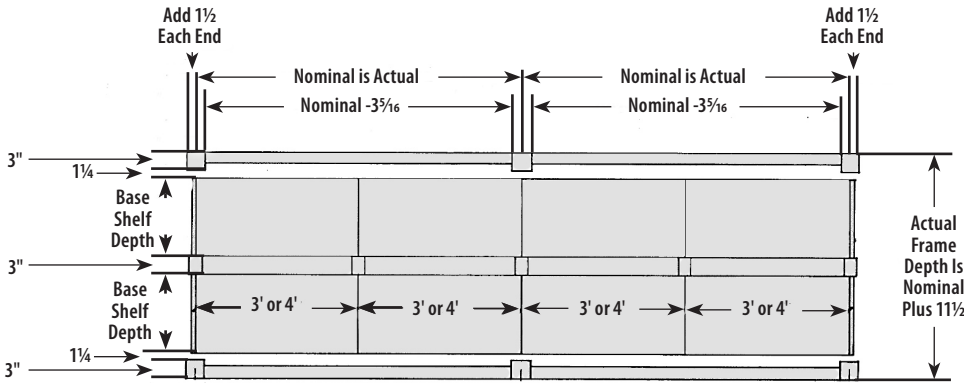
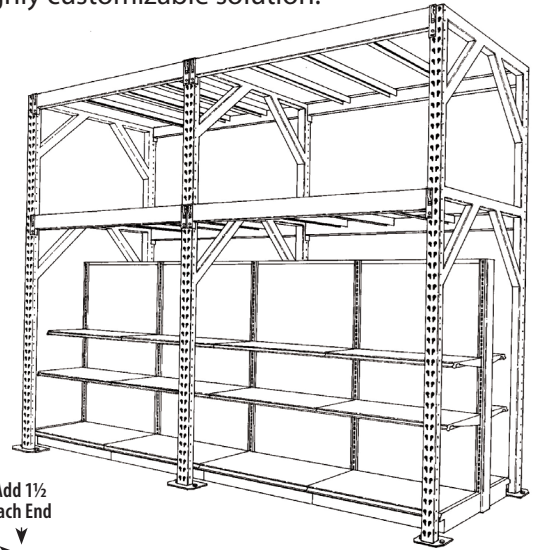

maxispan

### Maxispan Uprights

- Maxispan Uprights heights 84" to 144" (2134 mm to 3658 mm) fit over Gondolas Base Shelves 18" to 30" (457 mm to 762 mm) in depth
- Maxispan column load capacity is 20,000 lbs
- Standard finishes: Sahara or Blue Gray

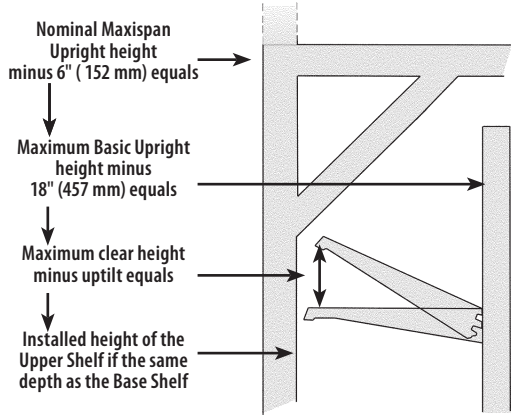

### MS2U(NH)-(ND)

- MS2.....Maxispan 2" OC (51 mm)
- U.....Upright
- NH.....Nominal Frame Height 84" to 144" in 6" increments (2134 mm to 3658 mm in 152 mm increments)
- ND.....Nominal Frame Depth 36", 40", 44", 48", 60" (914 mm, 1016 mm, 1118 mm, 1219 mm, 1524 mm)

Nominal Frame Length	For Gondola Base Shelves	Actual Frame Depth
36"	18" x 18"	47½" (1207 mm)
40"	20" x 20"	51½" (1308 mm)
44"	22" x 22"	55½" (1410 mm)
48"	24" x 24"	59½" (1511 mm)
60"	30" x 30"	71½" (1816 mm)

### Upright Construction

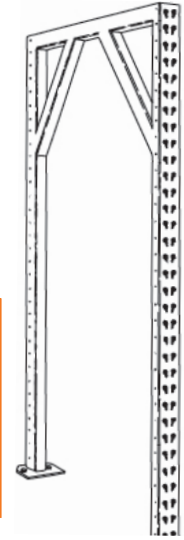
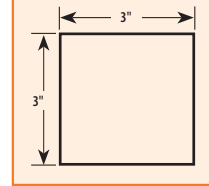

**NOTE!** To preclude overturning, the frame depth x 6 cannot exceed the height of the topmost loaded beam pair, unless all the frames are properly anchored or braced externally.

Maximum clear height minus uptilt equals figure in chart below

Shelf Depth	18"	20"	22"	24"	26"	28"	30"
Uptilt Clearance	6"	7"	8"	8"	9"	9"	10"

maxispan

### Maxispan Beams

- Available in three heights for differing load capacities
- Features choice of step sizes for either 5/8" (16 mm) particle board or 2" (51 mm) dimensional lumber decking
- Sized to place Uprights on 3', 4', 6', 7', or 8' (914 mm, 1219 mm, 1829 mm, 2134 mm, or 2438 mm) center lines
- Standard finish: Sahara or Blue Gray

### MS2B(NH)(NL)-(STEP)

- MS2.....Maxispan 2" OC (51 mm)
- B.....Beam
- NH.....Nominal Beam Height 3½", 5", 6" (89 mm, 127 mm, 152 mm)
- NL.....Nominal Beam Length 36", 48", 72", 84", 96" (914 mm, 1219 mm, 1829 mm, 2134 mm, 2436 mm)
- STEP.....1=¾" (19 mm)  
2=1½" (41 mm)

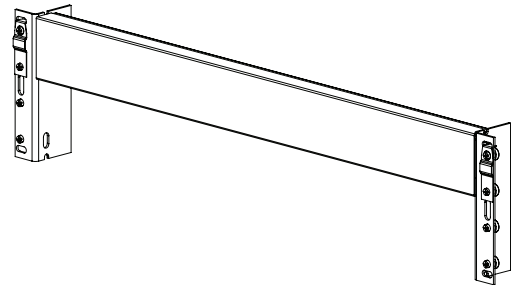
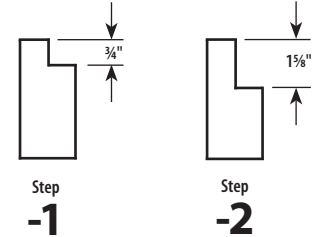

### Deck Supports

- Formed heavy gauge steel with tabs fit into beam slots
- Supports regular-duty decking
- Ties heavy-duty decking beams together to prevent rotation
- Order by frame depth, in quantities shown in table
- Standard finish: Sahara or Blue Gray

### MMSDS-(ND)

- MMS.....Maxispan 2" OC (51 mm)
- DS.....Deck Support
- ND.....Nominal Frame Depth 36", 40", 44", 48", 60" (914 mm, 1016 mm, 1118 mm, 1219 mm, 1524 mm)

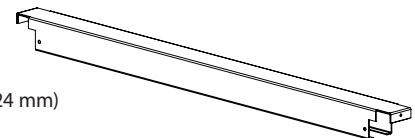

Deck Supports per Beam Length		
Beam Length	-1 Step	-2 Step
36" to 72"	2	1
84" to 96"	4	1

**Maxispan Flush Deck Support**

- Load bearing pallet support
- Use one pair per pallet
- Fits flush with top of beam
- Load capacity 5,000 lbs/pair
- Standard finishes: Sahara or Blue Gray

**MMSDSF(ND)(STEP)**

MMSDSF .....Maxispan Flush Deck Support  
 ND .....Nominal Frame Depth 36", 40", 44", 48", 60"  
 (914 mm, 1016 mm, 1118 mm, 1219 mm, 1524 mm)  
 STEP .....1=3/4" (19 mm)  
 2=1 1/8" (41 mm)

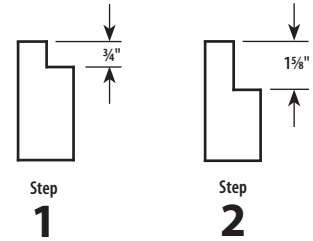
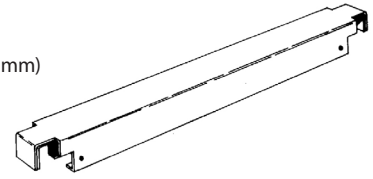

**Maxispan Base Deck Beam**

- Resists damage from carts and polishers
- Used at floor level to form kickplate
- Prevents trash from collecting under bottom deck
- Standard finishes: Sahara or Blue Gray

**MS2BDB-(NL)**

MS2.....Maxispan  
 BDB.....Base Deck Beam  
 NL.....Nominal Length 36" to 96" in 12" increments  
 (914 mm to 2438 mm in 305 mm increments)

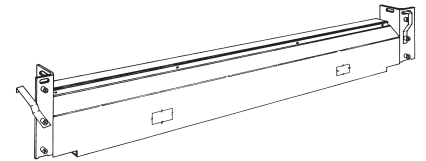

**Pallet Stop**

- Heavy-gauge angle aids in pallet positioning
- Easily attaches to decking or beam with supplied hardware
- Standard finishes: Sahara or Blue Gray

**PRPS-(NL)**

PRPS.....Pallet Rack Pallet Stop  
 NL.....Nominal Length 36" to 96" in 12" increments  
 (914 mm to 2438 mm in 305 mm increments)

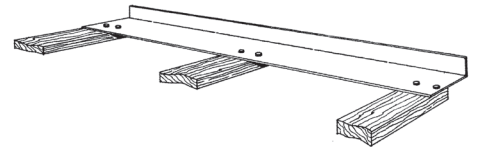

**Heavy-Duty Decking**

- Unfinished 2" (51 mm) dimensional lumber provides high load capacity
- Use with 2" (51 mm) style beams only
- Order by upright depth

**MMSHDD-(ND)**

MMS.....Maxispan  
 HDD.....Heavy-Duty Deck  
 ND.....Nominal Frame Depth 36", 40", 44", 48", 60"  
 (914 mm, 1016 mm, 1118 mm, 1219 mm, 1524 mm)

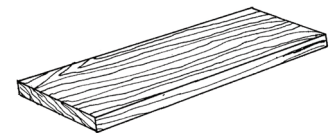

Nominal Frame Depth	Actual Length
36"	44 5/8"
40"	48 5/8"
44"	52 5/8"
48"	56 5/8"
60"	68 5/8"

• Order one piece per linear foot of beam

**Maxispán Waterfall Wire Grid Decks**

- Sturdy 5/16" (8 mm) diameter wire is welded on 3" (76 mm) grid centers to form decking
- Integral supports eliminate standard deck supports
- Standard finishes: Silver Vein, Sahara, or Blue Gray

**MSWFWGD(ND)(NL)-3**

- MS.....Maxispán
- WF.....Waterfall
- WGD.....Wire Grid Deck
- ND.....Nominal Frame Depth 36", 40", 48", 56", 60"  
(914 mm, 1016 mm, 1219 mm, 1422 mm, 1524 mm)
- NL.....Nominal Piece Length 24" to 48" in 6" increments  
(610 mm to 1219 mm in 152 mm increments)
- 3.....Grid Size 3" OC (76 mm)

Nominal Beam Length	Combine these Piece Lengths to equal beam length
36"	36"
48"	48"
60"	30" + 30"
72"	36" + 36"
84"	42" + 42"
96"	48" + 48"
108"	36" + 36" + 36"
120"	36" + 48" + 36"
132"	48" + 36" + 48"
144"	48" + 48" + 48"

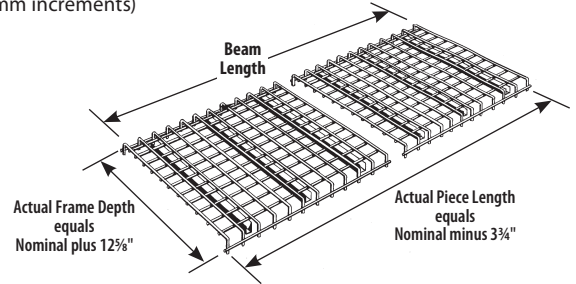

maxispán

**Maxispán Wire Grid Decks**

- Sturdy 5/16" (8 mm) diameter wire is welded on 3" (76 mm) grid centers to form decking
- Wire grid piece length runs parallel to beam length
- Standard finishes: Silver Vein, Sahara, or Blue Gray
- Order deck supports separately, 2 per piece

**MSWMS(ND)(NL)-3**

- MS.....Maxispán
- WMS.....Wire Grid Deck
- ND.....Nominal Frame Depth 36", 40", 44", 48", 60"  
(914 mm, 1016 mm, 1118 mm, 1219 mm, 1524 mm)
- NL.....Nominal Piece Length 24" to 48" in 6" increments  
(610 mm to 1219 mm in 152 mm increments)
- 3.....Grid Size 3" OC (76 mm)

Deck Type	Nominal Beam Length	Combine these Piece Lengths to equal beam length	Quantity of Deck Supports
One Piece Decks	36"	36"	2
	48"	48"	2
Two Piece Decks	60"	30" + 30"	4
	72"	36" + 36"	4
	84"	42" + 42"	4
	96"	48" + 48"	4
Three Piece Decks	108"	36" + 36" + 36"	6
	120"	36" + 48" + 36"	6
	132"	48" + 36" + 48"	6
	144"	48" + 48" + 48"	6

