

**Concave/Radius Upper & Base Shelves**

Madix's patented line of curved fixture components redefine stores by transforming shelving layouts from conventional to contemporary. Concave/Radius Upper Shelves, Base Shelves, Kickplates fit into standard Maxi Line Shelving. Alternate Concave Shelves with Madix's Radius Shelves and Kickplates to create a stylish serpentine gondola run. Madix has patented use of this combination of Concave/Radius shelving.

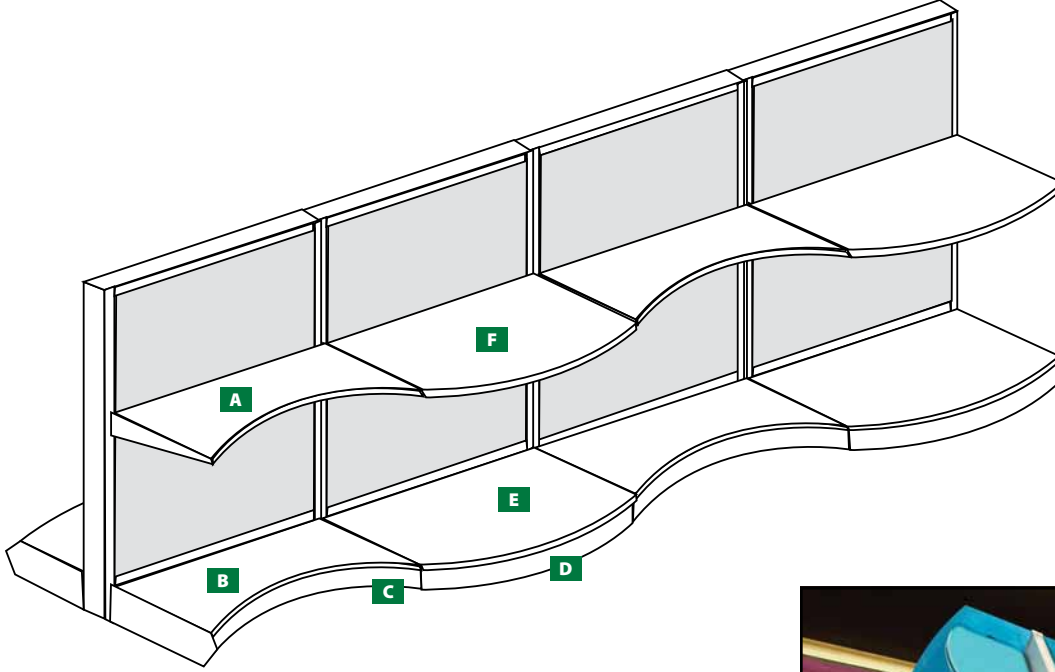

Description	Part Number
<b>A</b> Concave Upper Shelf	SUSMRFC(NW)(ND)-3-(TAG)
<b>B</b> Concave Base Shelf	SBSMRFC(NW)(ND)-3-(TAG)
<b>C</b> Concave Kickplate	SBSMRFCCKP03-(NW)
<b>D</b> Radius Kickplate	SBSMRFCP-(NW)-3
<b>E</b> Radius Base Shelf	SBSMRF-(NW)(ND)-3-(TAG)
<b>F</b> Radius Upper Shelf	SUSMRF-(NW)(ND)-3-(TAG)



**concave/radius shelving**

**Standard Upper & Base Shelf with Multi Radius Front**

- Innovative way to highlight a new product, hot sale item or an entire line of merchandise
- May be used in Madix standard Maxi Line fixtures, in line with Standard Upper Shelf and Standard Base Shelf to make a section stand out
- When used on both sides of an aisle, a unique scalloped effect is attained
- May also be used with end merchandisers to create eye-catching end cap displays that highlight new products or sale items
- Load capacity 500 lbs per shelf, not to exceed capacity of section as described in General Information section
- Laminate finish available

Radius Front Base Shelves are ordered by:

1. Deleting Standard Base Shelves from a standard wall or gondola section
2. Ordering the correct number of Radius Front Base Shelves

*All other section parts remain standard*

**(OPT)MRF-(NW)(ND)-(ED)**

- OPT.....SUS=Standard Upper Shelf  
SBS=Standard Base Shelf
- MRF.....Multi Radius Front
- NW.....Nominal Width 24" to 60" in 6" increments  
(610 mm to 1524 mm in 152 mm increments)
- ND.....Nominal Depth 08" to 30" in 2" increments  
(203 mm to 762 mm in 51 mm increments)
- ED.....Extension Depth 02" or 03"  
(51 mm or 76 mm)

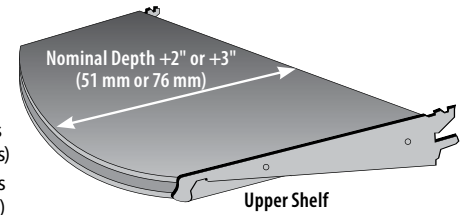

Upper Shelf

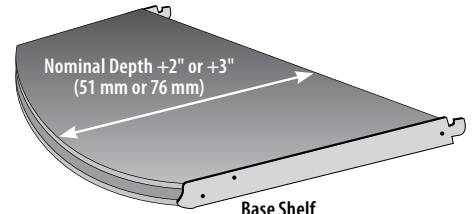

Base Shelf

**NOTES!**

Not available in Flush Front.  
Must use SUSRF in line with SUS Style Shelves.  
Must use STPSRF with STP Style Shelves.

**Radius Kickplate**

- Install by snapping into Base Shoes without disturbing Base Shelves
- Center portion measures 2" or 3" (51 mm or 76 mm) greater than Base Shoes used for unit
- Curve matches Radius Base Shelf

**SBSMRFKP-(NW)-(OPT)**

- SBS..... Standard Base Shelf
- MRF..... Multi Radius Front
- KP..... Kickplate
- NW..... Nominal Width 36" or 48"  
(914 mm or 1219 mm)
- OPT..... Extension Option 2" or 3"  
(51 mm or 76 mm)

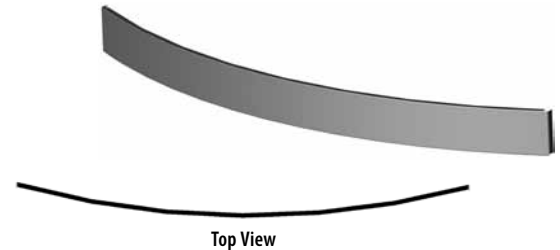

Top View

**Standard Upper & Base Shelf with Multi Radius Concave Front**

- Draws customers' attention to merchandise
- Gradual inward curve 2" or 3" (51 mm or 76 mm) less than depth of brackets at curve vertex
- Load capacity 500 lbs
- Standard DGA2 Tag Molding built into each shelf available in satin, gold, or customer's choice of finish
- Patented

**(OPT)MRFC(NW)(ND)-(ID)**

- OPT.....SUS=Upper Shelf  
SBS=Base Shelf
- MRFC..... Multi Radius Concave Front
- NW..... Nominal Width 24", 36" or 48"  
(610 mm, 914 mm or 1219 mm)
- ND..... Nominal Depth 10" to 24" in 2" increments  
(254 mm to 610 mm in 51 mm increments)
- ID..... Inversion Depth 2" or 3"  
(51 mm or 76 mm)



Bottom View



Top View

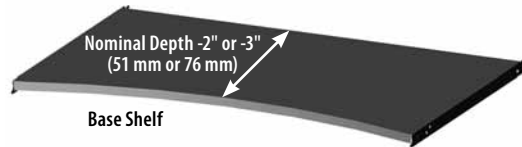
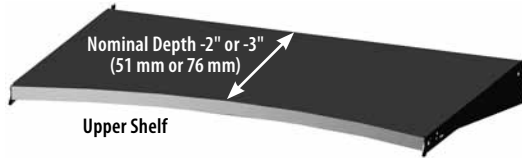

**Concave Kickplate**

- Install by snapping into Base Shoes without removing Base Shelves
- Center portion of Kickplate 2" or 3" (51 mm or 76 mm) less than Base Shoes used for unit
- Curve matches Radius Base Shelf

**SBSMRFC(KP)(ID)-(NW)**

- SBS..... Standard Base Shelf
- MRFC..... Multi Radius Front Concave
- KP..... Kickplate
- ID..... Inversion Depth 2" or 3"  
(51 mm or 76 mm)
- NW..... Nominal Width 36" or 48"  
(914 mm or 1219 mm)

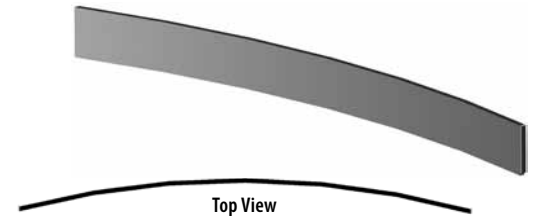

**Standard Upper & Base Shelf with Radius Front**

- Load capacity 500 lbs per shelf, not to exceed capacity of section as described in General Information section
- Gradual outward curve 6" (152 mm) greater than depth of brackets at curve vertex
- Available in Regular-Duty or Heavy-Duty
- Laminate finish available

**(OPT)RF(TYPE)-(NW)(ND)**

- OPT.....SUS=Upper Shelf  
SBS=Base Shelf  
STPS=Three Position "Straight in" Insertion
- RF..... Radius Front
- TYPE..... Blank=Regular-Duty  
HD=Heavy-Duty
- NW..... Nominal Width 3' or 4'  
(914 mm or 1219 mm)
- ND..... Nominal Depth 12" to 30" in 2" increments  
(305 mm to 787 mm in 51 mm increments)

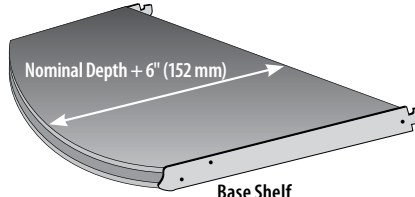
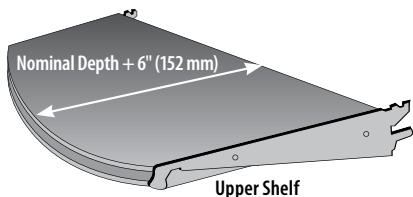

concave/radius shelving